



CARE INSTRUCTIONS

Wipe the parts with a damp cloth soaked in warm water and a bit of mild detergent. Use only soft cloth for wiping and polishing, never sponges or steel wool. Do not use abrasive household cleaners. Do not use acidic or alkaline cleaning materials, glass cleaner or household ammonia.

TROUBLESHOOTING

If lamp does not light, turn off the power. Check the bulb for a broken filament. Replace bulb if necessary, then turn it on. If the lamp still does not light, please contact customer service at the local dealer. If the external flexible cable or cord of this lamp is damaged, it must be replaced by a qualified electrician in order to avoid a hazard.

TECHNICAL INFORMATION

Light sources: E14, 470 Lumen ($\leq 40W$ Incandescent, $\leq 30W$ Halogen, $\sim 5-6W$ LED Dimmable).. Turn power off when changing light bulb. Isolation class II. The lamp is not approved for outdoor use or use in damp/wet rooms (IP20).



For enquiries contact GUBI A/S - CVR: 17940384
Klubiensvej 7-9, 2150 Nordhavn, Copenhagen, Denmark
T +45 69 15 60 60 – order@gubi.dk
GUBI.COM

58-20-009-03 Assembly Instructions Multi-Lite Pendant S EU.

GUBI

ASSEMBLY INSTRUCTIONS

for

Multi-Lite Pendant S

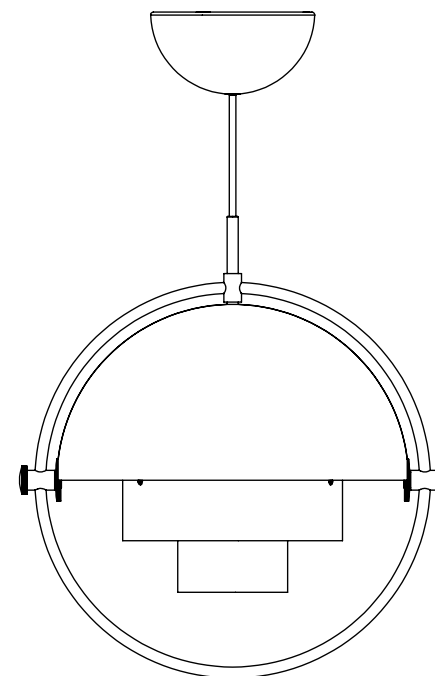

CONTENTS.

MULTI-LITE PENDANT S

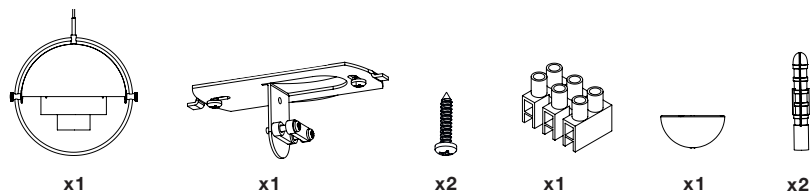

The half-shades can be moved, and tightened by turning the fixing screw.

1. Assembly

Attach the ceiling bracket to the ceiling where the mains voltage exits.

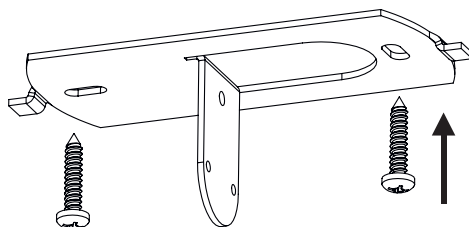

3.

Connect lamp cable to the supply wires.

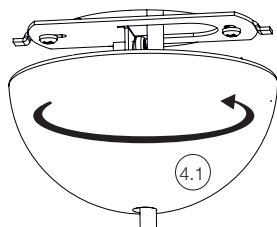
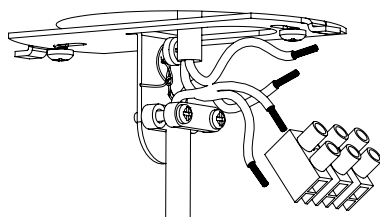

2.

2.1 Find the desired length of cable and cut off the outer isolation.

2.2 Mount the cable in the cable clamp.

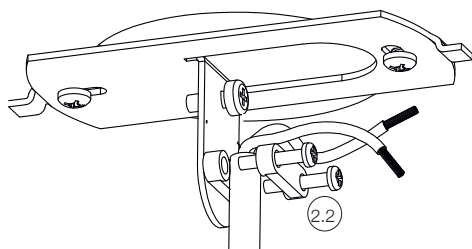

4.

4.1 Place canopy on ceiling bracket and twist approx. 5 - 20 degrees.

4.2 Place light bulb in lamp and turn the power on.

1. Change hanging direction 2.

Loosen the lower screw in the ring.
Do not screw it completely out of the thread.

Hold the inner parts (cylindrical shades) tight.

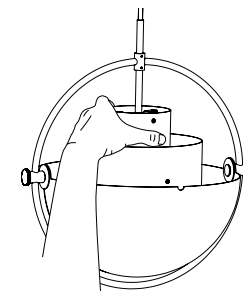
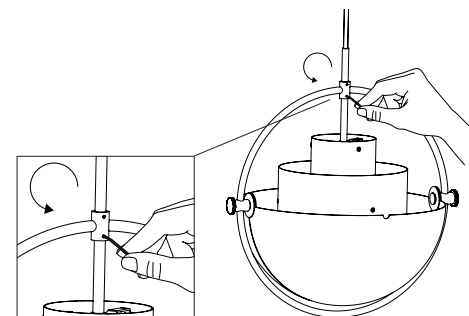

3.

Turn the ring to the position you want.

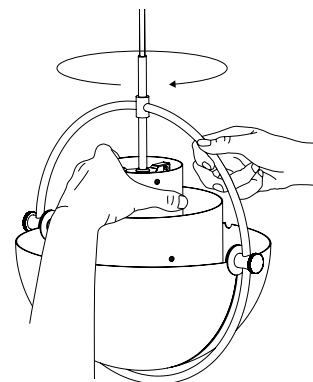

4.

Tighten the lower screw again.

You might need to do this a few times as the cable tends to turn over time.

